

# Adeline Jay Geo-Karis Illinois Beach State Park

**No Possession or Consumption of Alcohol on any site**

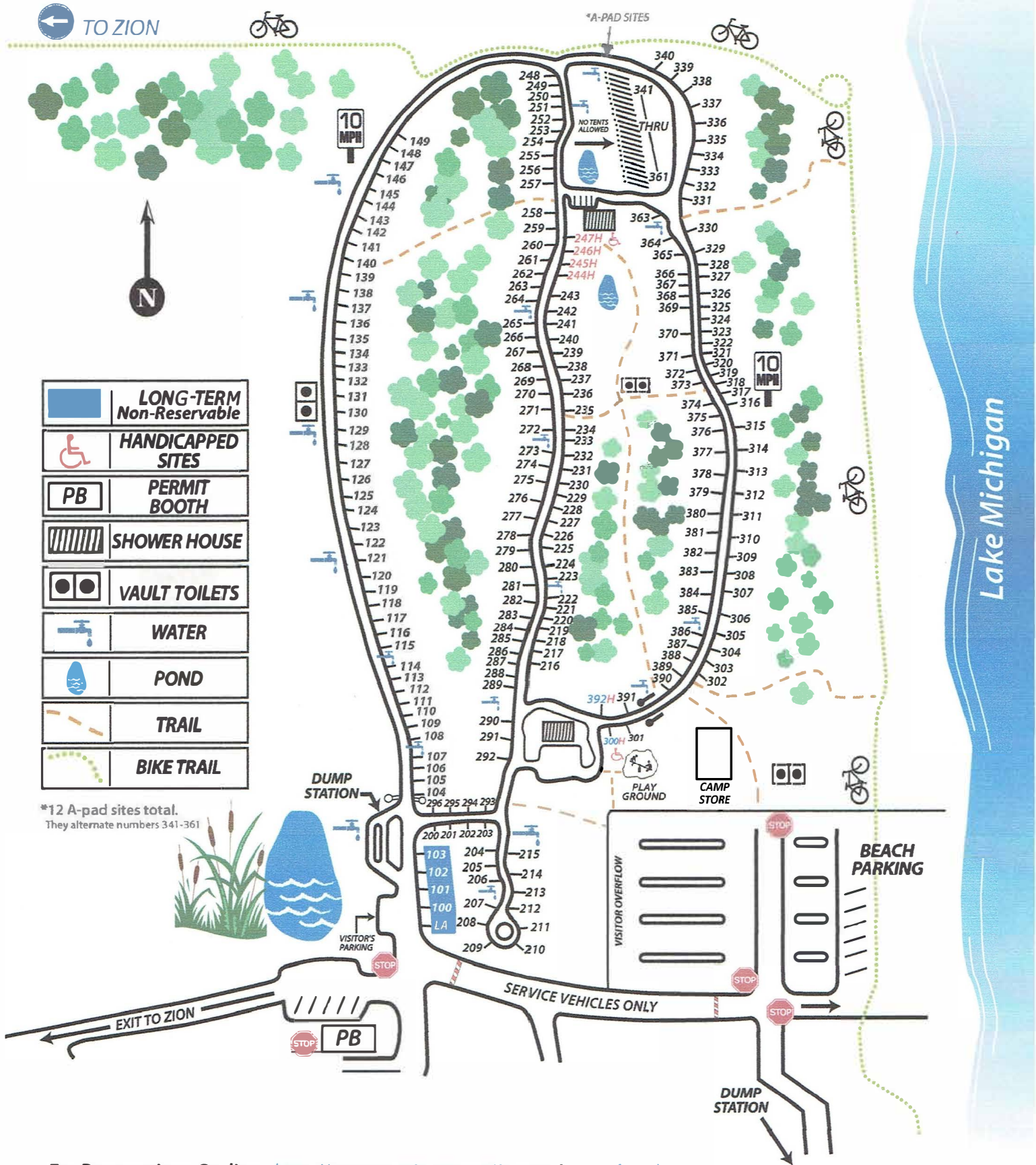

	<b>LONG-TERM Non-Reservable</b>
	<b>HANDICAPPED SITES</b>
	<b>PERMIT BOOTH</b>
	<b>SHOWER HOUSE</b>
	<b>VAULT TOILETS</b>
	<b>WATER</b>
	<b>POND</b>
	<b>TRAIL</b>
	<b>BIKE TRAIL</b>

\*12 A-pad sites total.  
They alternate numbers 341-361

- For Reservations On-line: <http://camp.exploremoreil.com> Phone: (866) 716-6550
- Reservations can be made six (6) months out & up to three (3) days prior to arrival.
- Cancellations can be made up to three (3) full days prior to arrival to get a full refund minus fees.



# ILLINOIS BEACH STATE PARK CAMPING RULES

## No Consumption or Possession of Alcohol Allowed on Any Campsite

1. The maximum length of stay for a camping party and/or the camping unit is limited to 14 camping nights within any 30 day period.
2. The campground gates are locked from 10pm to 8am. During this time, you may leave the campground but not enter.
3. You **must have your Camping Unit/Shelter with you to obtain a Camping Permit**. Camp shelter must be put up at time of registration.
4. A "family" consists of parents/guardians and unmarried children - **NO MULTIPLE FAMILIES**. A "single group" consists of 4 individuals. A group may occupy up to two tents, four single-person tents, or one camper and one tent, on a single campsite. Each "family" must occupy separate camps.
5. **Check out is 3pm daily**. Anyone staying past this time may be required to pay for an additional night.
6. Visitors (unregistered campers) must leave the park by **9pm every night**.
7. **No more than two motorized vehicles per site**. Park on gravel pads only.
8. **No Consumption or Possession of Alcohol is allowed anywhere in the Park**, other than the hotel and camp store patio.
9. **It is UNLAWFUL to drain or dispose of water/waste directly onto the ground**, including that from sink drains. Put in covered container and empty at sanitary dump stations.
10. **Quiet pets** are welcome as long as they are on a leash, not to exceed 10' and under specific physical control at all times. Do not leave unattended. Cleaning up after pets is the responsibility of each owner. Do not tie pets to trees.
11. Please observe quiet hours: **10pm to 7am**; radios, televisions, generators, and voices must be kept at a level not to disturb other campsites.
12. Please DO NOT wash dishes or pets in the bathhouses/restrooms.
13. Keep your fires in camp stoves provided, or in your own burners.
14. NO gathering of firewood.
15. **If you move picnic tables onto the same site, please move them back before you leave. There should be one table per camp site.**
16. Washing vehicles not permitted.
17. Camper's copy of permit **must be displayed on post immediately after registering or you will lose your site.**

## EMERGENCY TELEPHONE NUMBERS

911 (Ask for Lake County Sheriff or Beach Park Fire & Rescue)

Permit Booth: 847/257-6086

Lake County Sheriff: 847/549-5200

Illinois State Police: 847/931-2400

**IN THE EVENT OF AN EMERGENCY,  
REPORT PROBLEM IMMEDIATELY TO THE PARK OFFICE, PARK STAFF, OR CAMPGROUND HOST.**



Adeline Jay Geo-Karis  
Illinois Beach State Park  
Lakefront/Park Office  
Zion, Illinois 60099  
phone: 847/662-4811